

NOTES

1. Manhole chambers and chimneys flush joint Class 'S'
2. All flush joints to be sealed with expandite BM100 or approved equivalent.
3. Concrete in slabs and adjustment rings to be a minimum of 21MPa at 28 days. Mass concrete to be 21MPa at 28 days. Concrete to be of ordinary grade.
4. Drop manholes are to be used on inlet lines with a max diameter of 225mm and where the difference between the soffit of outlet is greater than 600mm.
5. If further internal drop connections are expected, design manhole diameter may be increased (ie. 1050Ø → 1200Ø)
6. Refer TS 406 for adjustment ring details.
7. Diameters of precast manhole pipes are nominal only.

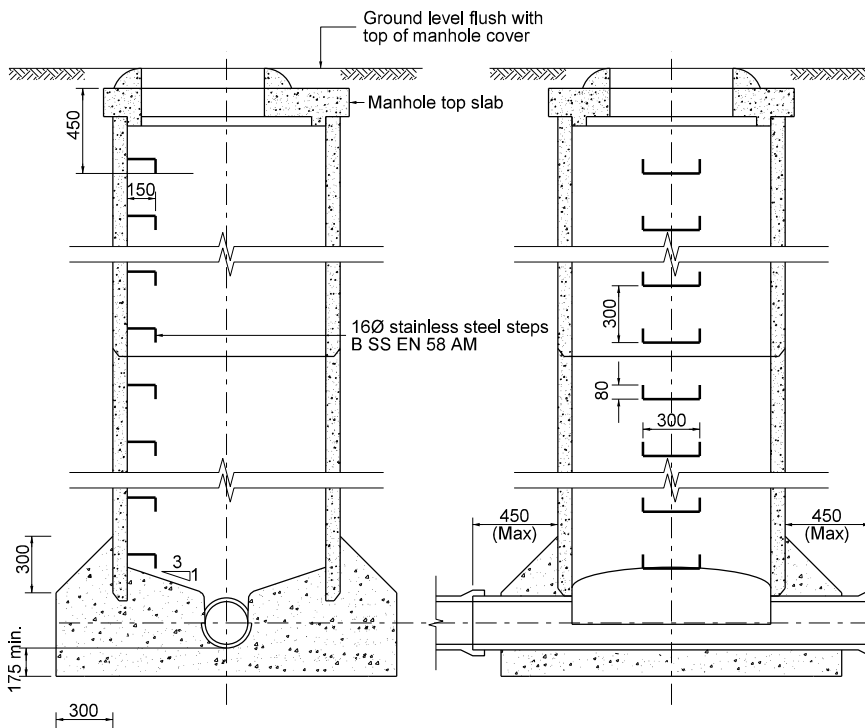

DETAILS 1050Ø & 1200Ø MANHOLES

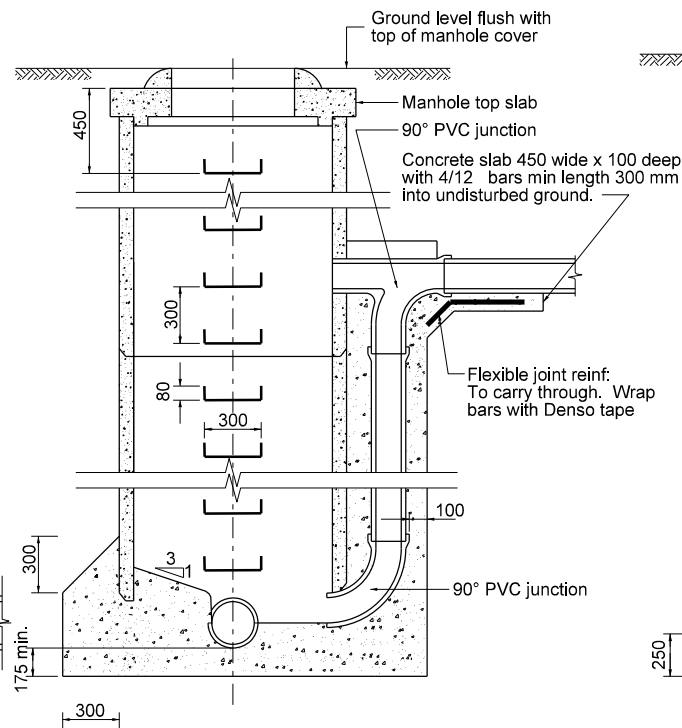

DROP MANHOLES
(Sanitary Sewer Only)

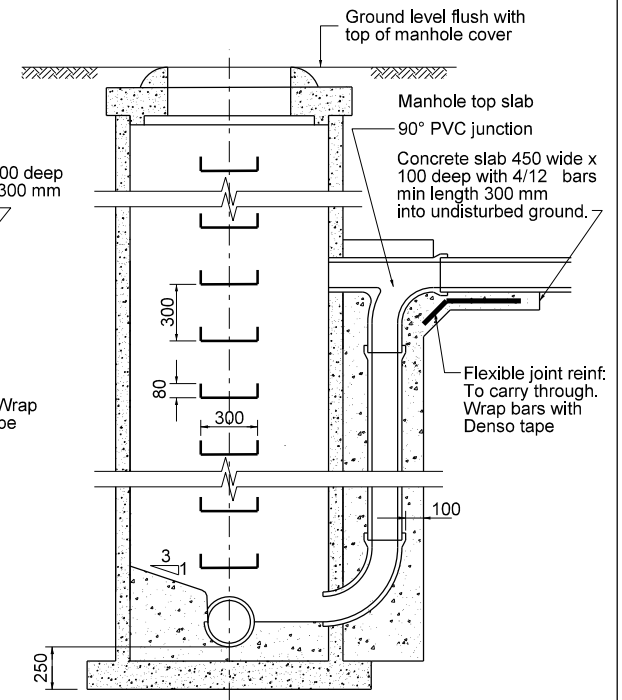

DROP MANHOLES WITH EXTERNAL DROP
PRE-CAST BASE
(Sanitary Sewer Only)