

- CABLE DUCTS**
- ① 100mmØ PVC Duct - Pump Power
 - ② 100mmØ PVC Duct - Floats/Level Sensors
 - ③ 50mmØ PVC Duct - Solenoid Valves (If any sparges installed)
 - ④ 50mmØ PVC Duct - Overflow Float (If remotely installed)
 - ⑤ 50mmØ PVC Duct - Flow Meter
 - ⑥ 100mmØ PVC Duct - Power Inlet

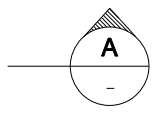

- NOTES**
1. Internal diameters of pipe and flow meter are to be matched. If this is not possible use an undersize flow meter joined to pipe with reducers. (Reducing angle <math><8^\circ</math>.)
 2. Flow meter is to have a calibrated fingerprint by manufacturer before installation.
 3. Pump station design must ensure flow meter is fully charged during non-pump operation.

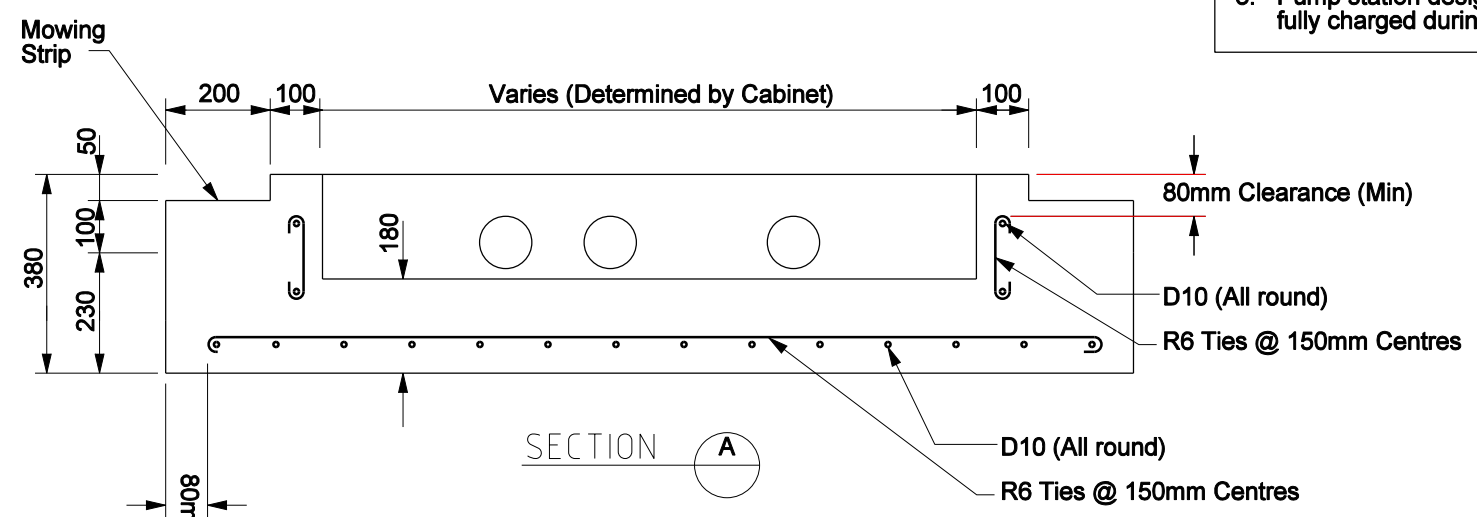

CONCRETE CONTROL CABINET PLINTH
(Concrete Strength 35 MPa @ 28 days)

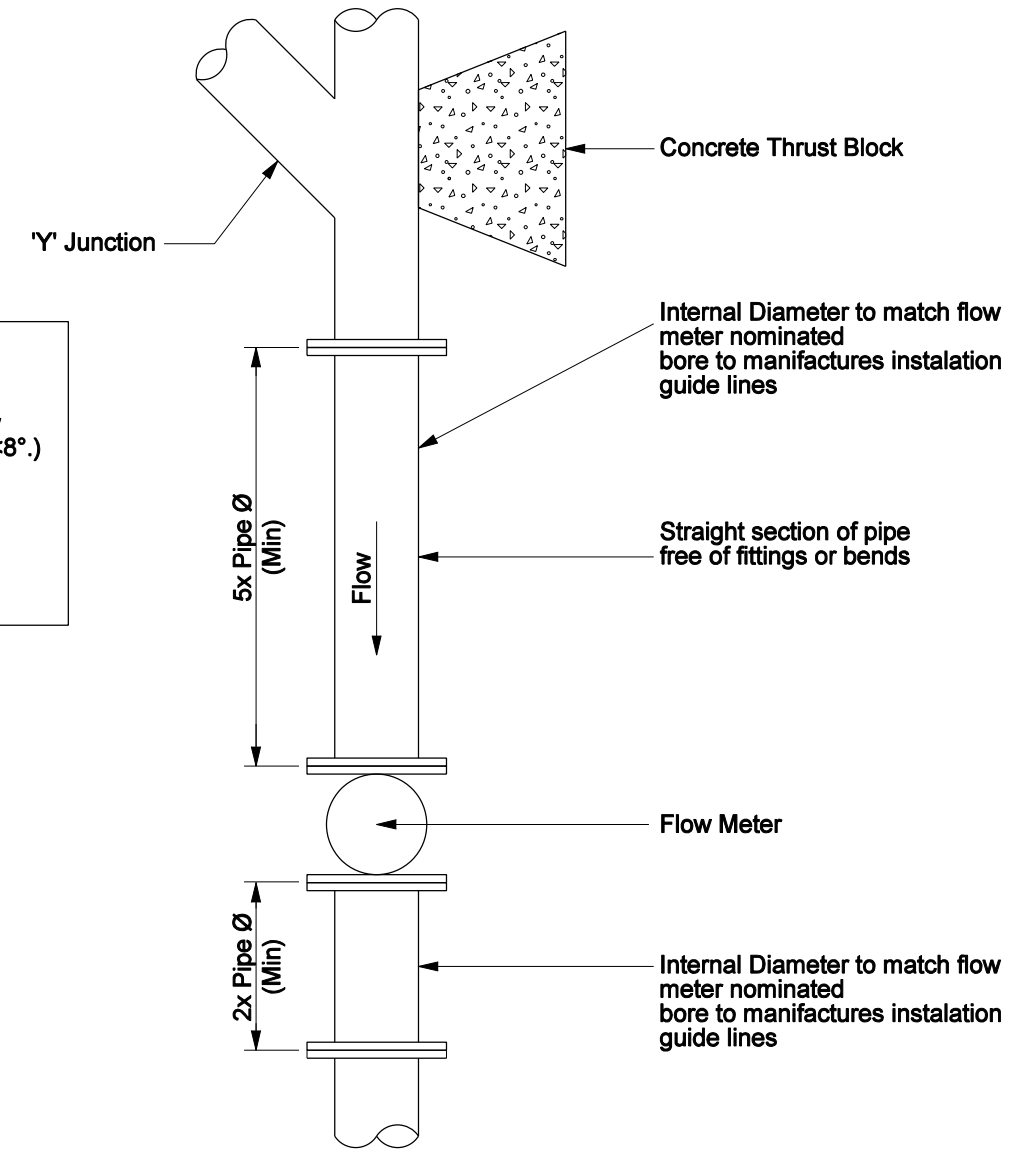

FLOW METER INSTALLATION DETAILS